

# DIVE IN

- = No Vehicular Access
- = Platform & Depths (m)
- = Training Area
- = Underwater Rope
- = 30m NAV Line
- = You are here
- = Lake Buoys

Main Road

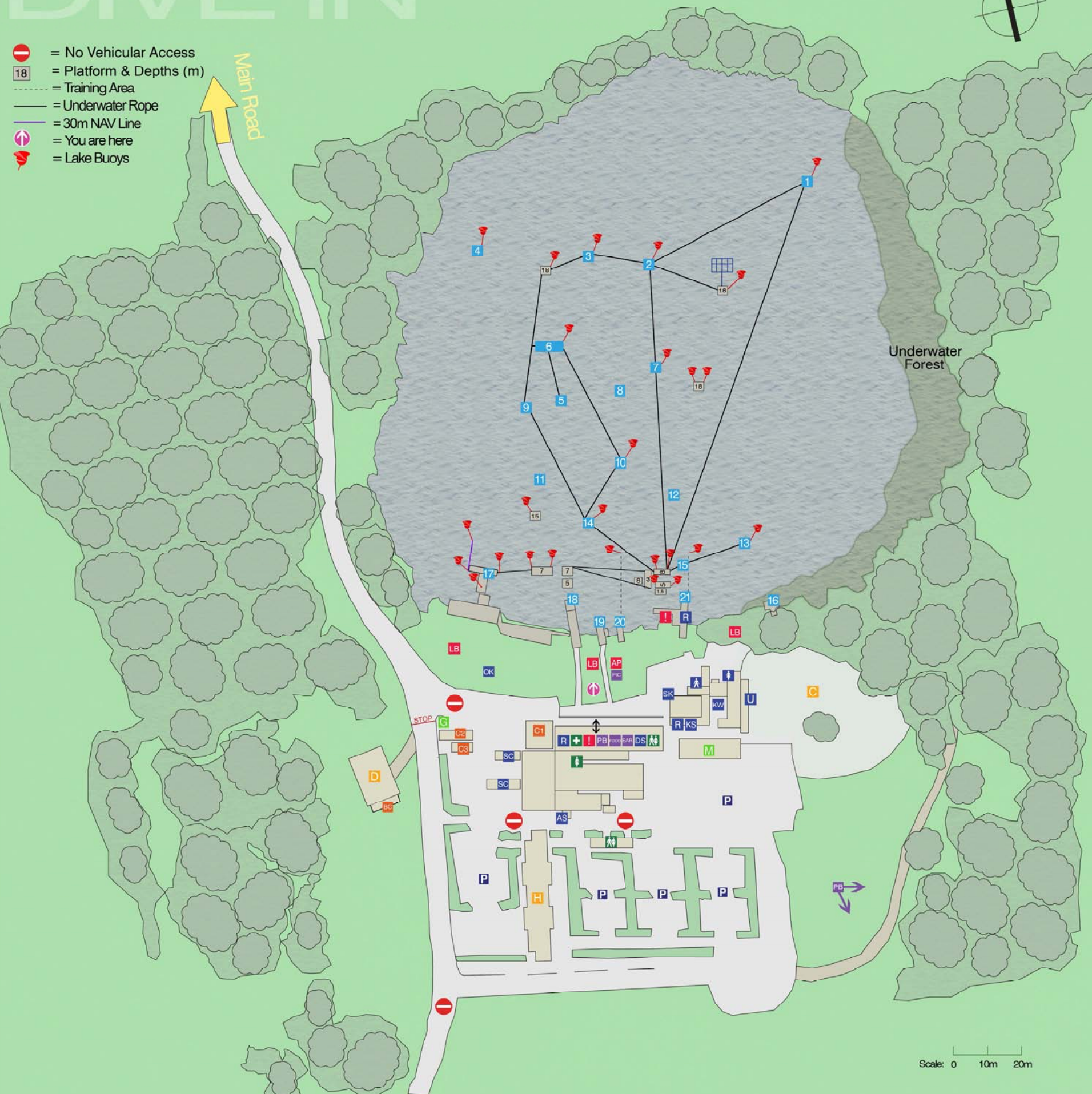

# GILDENBURGH DIVING CENTRE

# DIVE IN

### Lake Features:

- 1** Yacht (8m deep)
- 2** Coach (18m deep)
- 3** Barge (20m deep)
- 4** Cabin Cruiser (16m deep)
- 5** Polski-Fiat (17m deep)
- 6** Jet Provost (17m deep)
- 7** Hut/ Platform (19m deep)
- 8** Morris Minor (18m deep)
- 9** Line Anchor Point
- 10** Lorry (19m deep)
- 11** Rowing Boat (17m deep)
- 12** Car/ Boat (18m deep)
- 13** Sky Van (16m deep)
- 14** Bus (7-15 m deep)
- 15** Water Tank (6m deep)
- 16** Floating Jetty
- 17** Rescue Platforms
- 18** Disabled Ramp Entry
- 19** Giant Stride Entry
- 20** Thunder Flash Drop
- 21** Training Area/ Entry

### Dry Washrooms:

- Male Toilet
- Female Toilet
- Male/ Female Toilet

### Entertainment:

- Food & Drink Area
- Picnic Area (No Dive Kit)
- Bar
- Paintball Reception

### General:

- Marquee
- Gate Hut

### Accommodation:

- Caravan Park
- Private Dwelling
- Hotel

### Diving Utilities:

- Male Changing Rooms (WET)
- Female Changing Rooms (WET)
- Student Kit-Up Area (Dive In Only)
- Kit Wash-down Area
- Kit Store
- Services Centre
- Reception/ Dive Shop
- Air Station & Service Centre
- Open Kit-Up Area
- Utility
- Site Rules

### Training:

- Classroom 1
- Classroom 2
- Classroom 3
- Basement Classroom

### Safety Features:

- First Aid
- Emergency Alarm
- Life Buoy
- Assembly Point

designed & produced by...



www.a4plus.co.uk

Engineering & Design Services  
CAD Bureau Services  
Technical Recruitment

Scale: 0 10m 20m